

"EAST"

NW Cor. Sec. 4
T5N, R15E

Fd. 1" I.P.
Accept. As
Pt. on E.
Line Fremont

Fd. Alum. Mnt.
N 1/4 Cor. Sec. 4, T5N, R15E

PLAT OF SURVEY

SURVEYOR'S CERTIFICATE

I, JAMES K. LANGONE, REGISTERED LAND SURVEYOR, CERTIFY THAT I HAVE SURVEYED THE PROPERTY HEREIN DESCRIBED:

LOTS 1, 2, 3, AND THE SOUTHERLY 10 FEET OF LOT 4, ALL IN BLOCK 5, OF DUANE STARIN'S ADDITION TO THE CITY OF WHITEWATER. IN THE CITY OF WHITEWATER, WALWORTH COUNTY, WISCONSIN.

AND THAT THE PLAT SHOWN HEREON IS A CORRECT REPRESENTATION OF THE BOUNDARIES THEREOF.

JAMES K. LANGONE

DATE: 2/23/96

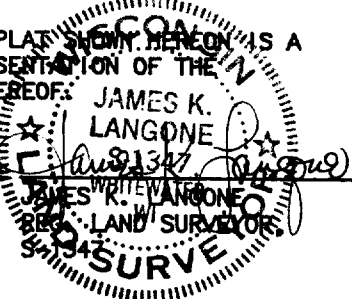

NOTES:

- — INDICATES SET 3/4" X 24" IRON ROD
- () — INDICATES RECORD DISTANCE
- R&M — INDICATES DISTANCE REC. & MEA.
- — INDICATES MONUMENT FOUND AS NOTED
- — INDICATES CONC. MONUMENT FOUND

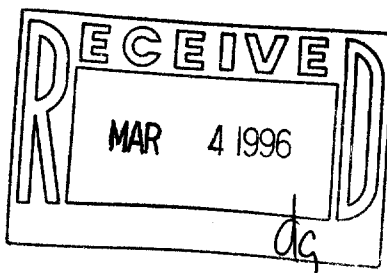

BASIS OF BEARINGS:
THE N. LINE SEC. 4, T4N, R15E
BEING "EAST"

BLK

PROSPECT ST.

S89°36'27"W 199.78' (198')

Fd. 1/2" I.P. Accept.
As Pt. on N. Line
Lot 11 0.40 W
LOT 11

Fd. 1/2" I.P. Bent S.
0.73 E LOT 10 0.27 E

LOT 9

LOT 8

LOT 7 Fd. 1" I.P.
Accept. As
Pt. on W. Line
Fremont

LOT 6

LOT 5 Fd. 1/2" Rod
Accept. As
Pt. on W. Line
Fremont

LOT 4

Fd. 1" I.P.
Accept. As
Pt. on W. Line
Lot 4

LOT 3

LOT 2

LOT 1

200.31' (198')

N89°55'04"E

STARIN ROAD

(Formerly PRATT STREET)

FRANKLIN ST.

PARK ST.

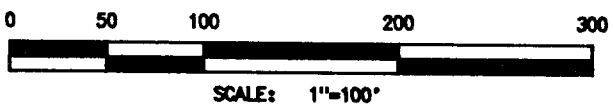

JAMES K. LANGONE

LAND SURVEYS & CIVIL ENGINEERING

N339 Co. Rd. "N" (Upper)

Whitewater, WI. 53190-2842

(414) 473-4119

JN: 96-100

15-14
10-574